



INSTALLATION GUIDE

LYNX SIDING SYSTEM

Table of contents



1. Introduction

- 1.1 Basics
- 1.2 Scope of Profiles
- 1.3 Scope of Substructure and Accessories
- 1.4 Planning and Preparation
 - Expansion/Contraction
 - Trim
 - Pinning
 - Corner Pieces
 - Air Barrier Requirements
 - Edge Pen

2. Installation-Procedure

- 2.1 Substructure
- 2.2 Trim and Accessory Option
- 2.3 Horizontal Siding Application
- 2.4 Multi-Board Horizontal Siding Application
- 2.5 Vertical Siding Application
- 2.6 Multi-Board Vertical Siding Application

3. Safety Warning and Product inquiries

1. Introduction

Designed with flexibility, sustainability and simplicity in mind.

Panels made of aluminum are modern solutions for cladding your facade. They are made of durable, high-quality materials and are convincing outdoors as well as for interior applications.

Panels made of aluminum that defy wind, cold and any weather.



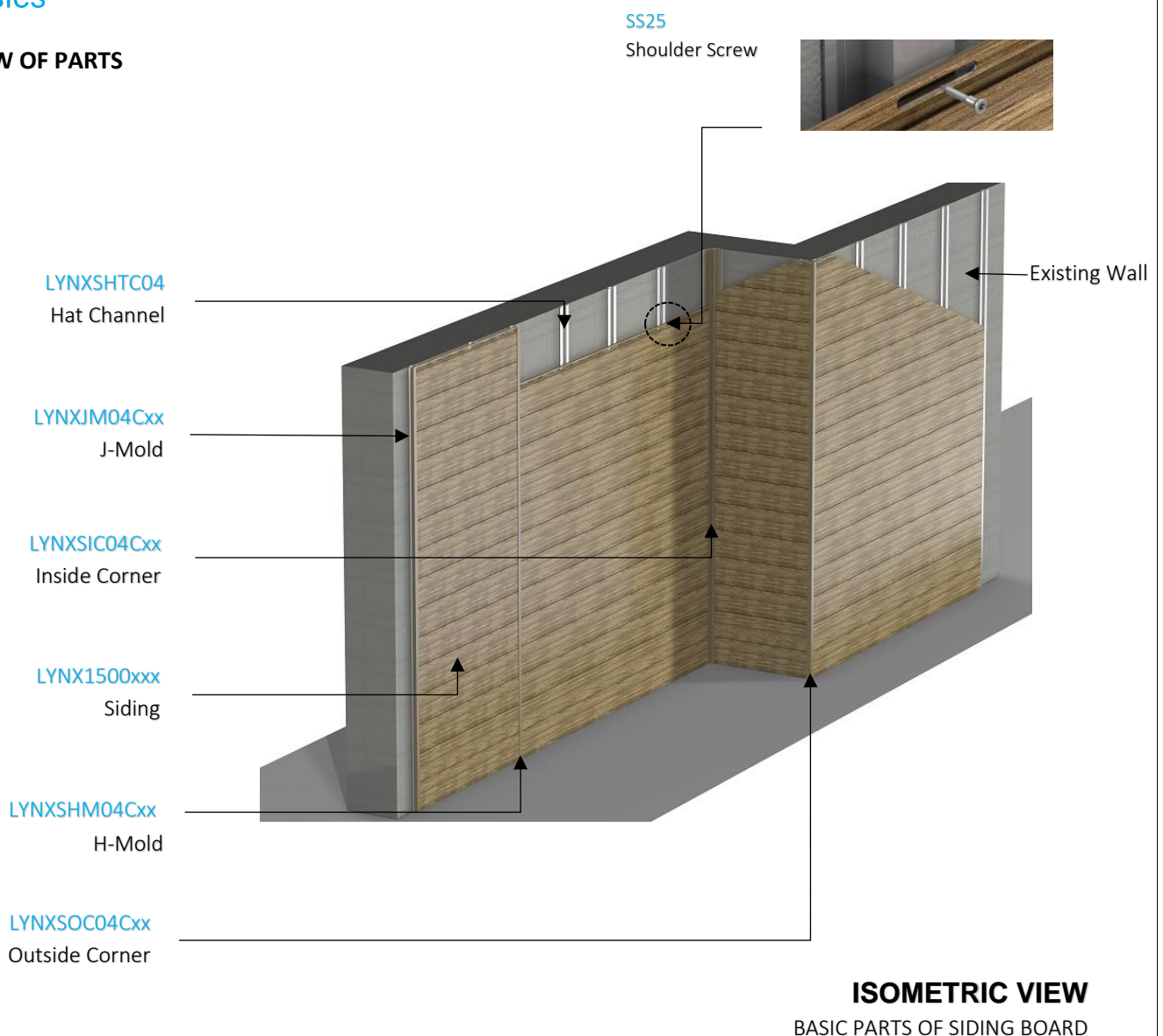

Due to their high recyclability, these panels are particularly environmentally friendly. Their low weight guarantees that facades are only insignificantly stressed. They are nonflammable, weather resistant and perform extremely well in all weather conditions.

1.1 Basics

OVERVIEW OF PARTS

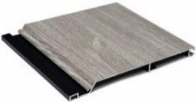

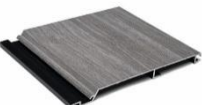
1.2 Scope of Profiles

FOTO	ARTIKELNR.	PROFIL (Stärke/Breite)	EINHEIT	LÄNGE	GEWICHT
	LYNX1500401 LYNX1000401	Lynx Alpine Ash (12mm/150 mm) (12mm/100 mm)	6 Stk.	4 m	24 kg 16 kg
	LYNX1500402 LYNX1000402	Lynx Royal Oak (12mm/150mm) (12mm/100 mm)	6 Stk.	4 m	24 kg 16 kg
	LYNX1500403 LYNX1000403	Lynx Silver Beech (12mm/150mm) (12mm/100 mm)	6 Stk.	4 m	24 kg 16 kg
	LYNX1500404 LYNX1000404	Lynx American Walnut (12mm/150mm) (12mm/100 mm)	6 Stk.	4 m	24 kg 16 kg
	LYNX1500421 LYNX1000421	Lynx Anthracite (12mm/150mm) (12mm/100 mm)	6 Stk.	4 m	24 kg 16 kg

1.3 Scope of Substructure and Accessories

PHOTO	ITEM NO.	PROFILE	UNIT	LENGHT	WEIGHT
	SS25	Shoulder Screw 3,5x25mm, V2A (1000 Stk.)	PC	--	4,5 kg
	LYNXJS04	Starter J-Strip	PC	4 m	0,45 kg
	LYNXJM04Cxx	J-Mold	PC	4 m	1,2 kg
	LYNXJWM04Cxx	Window J-Mold	PC	4 m	1,5 kg
	LYNXSOC04Cxx	Outside Corner	PC	4 m	1,6 kg
	LYNXSIC04Cxx	Inside Corner	PC	4 m	1,8 kg
	LYNXSHM04Cxx	H-Mold	PC	4 m	1,6 kg
	LYNXSHTC04	Hat Channel	PC	4 m	0,9 kg
	LYNXSHTC04P	Hat Channel Punched Mill Finish	PC	4 m	0,9 kg

Table 1.1 "Scope of Delivery"

NOTE: Table above shows products commonly used for wall siding. To view a complete list of products, please refer to our LYNX brochure or visit our website www.lynx-designs.com

1.4 Planning and Preparation

IMPORTANT: Five Major Bullet Points You Must Follow for a Successful LYNX Siding Installation

- **Preinstallation of Substructure**
- **Screw Placement**
- **Room for Expansion and Contraction**
- **Hard Fastening of each Plank**
- **Top to Bottom Ventilation**

NOTE:

Proper planning of the siding layout is essential for ease of installation of siding boards and siding components. Thoroughly read the following siding assembly instructions and obtain all necessary building permits prior to starting your installation. Decide finishing and trimming options prior to starting the project to ensure siding finishing detail is uniform for all sides of the building. Installation is the sole responsibility of the installer. LYNX assumes no responsibility whatsoever with respect to the installation. The information contained herein is provided for guidance purposes only and should not be relied upon as any absolute representation by LYNX.

Safety Tips:

1. Always check for power, gas, and water lines before installing.
2. Always wear safety glasses when operating power equipment.

Assembly Tips:

1. Battens should be flat and level to each other. Siding will follow the contour of the wall.
2. Lynx siding system is not a rain screen or waterproof system. Lynx siding is a water shed system.
3. Proper wall preparation according to local building codes and wall covering manufacture's recommendations should be adhered to. This includes but is not limited to flashing all openings.
4. All holes should be predrilled and installation holes should be slotted.
5. Only use construction fastening material and hardware suitable for outdoor use (e.g. stainless steel screws). Recommended is the use of SS25 shoulder screw.
6. Always consider the linear expansion of aluminum, which is dependent on the temperature but not the air humidity. See Table 1.4 "LYNX Expansion" for more information.
7. Cutting to length should be carried out at consistent material temperature. Therefore, the material should be stored in the shade or in areas where it is not exposed to direct sunlight. The material can warm up considerably in the sun, leading to an increased change in length. In the case of more distinct fluctuations in material temperature, cutting to length may have to be adapted accordingly.
8. Please store Lynx products flat on level surface.

Code Compliant Batten Spacing

Part Number	Part Description	Batten Span (cm)
LYNX6012xx	Siding Board Flat 150mm x 12mm	40 cm
LYNX4012xx	Siding Board Flat 100mm x 12mm	40 cm

Table 1.2 "Batten Spacing Requirements"

Expansion / Contraction of Siding

LYNX Expansion – Contraction Guide	
Profile Length	4 m
Expansion / Contraction amount (approx. 0,2% over 32° C variation in temperature)	0,8 cm

Table 1.3 Expansion – Contraction

Average expected expansion – contraction (this can vary based on geographical region).

LYNX Siding Board Gap Guide					
Temperature at Installation	Trim Gap of Siding Boards				H-Mold Gap
	below 0° C	15° C	30° C	45° C	
Amount for Siding Profile Length of 4 m	0,6 cm	0,5 cm	0,2 cm	0 cm	0,6 cm

Table 1.4 "LYNX Expansion"

Ensure a steady material temperature when cutting the boards to size, i.e. the cutting has to be done under constant conditions, e.g. inside or in shade.

Always consider linear expansion of LYNX profiles during the installation of siding products. If temperatures fluctuate during the installation, the gaps placed between the ends of the boards and a corner, window, or door must change with the temperature. Use the guide above to gap boards during installation.

TRIM

When a siding board in either a horizontal or vertical application terminates into a wall, eave, window, door etc. a J-Mold should be used to cover the exposed end of the siding board. The J-Mold should also be used along the bottom of a vertical installation. J-Mold trim should be pre-applied prior to installing siding boards. In the case of an intersecting joint the starter strip should be installed butted against the J-Mold trim, not overlapping the J-Mold trim attachment flange. Follow the gap guide when installing the siding board to allow for expansion and contraction within the J-Mold trim.

HORIZONTAL APPLICATION

ISOMETRIC VIEW DETAIL

SIDING J MOLD

6 cm from wall end
to centre hat channel

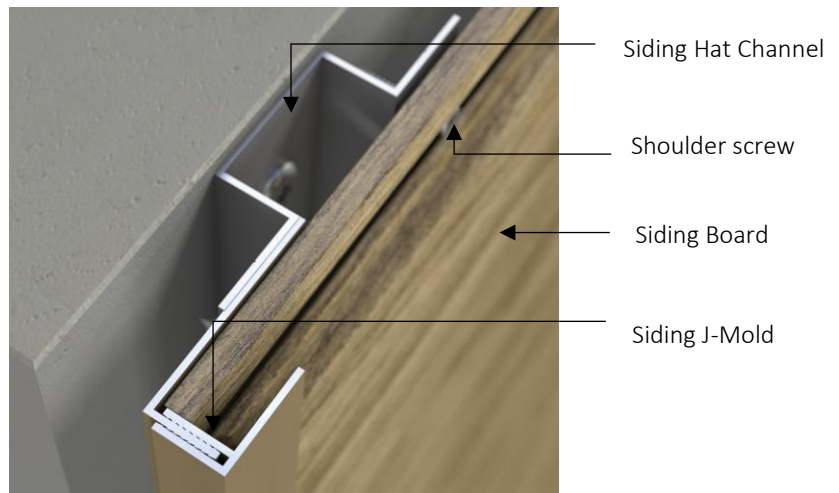

VERTICAL APPLICATION

TOP VIEW

SIDING J MOLD

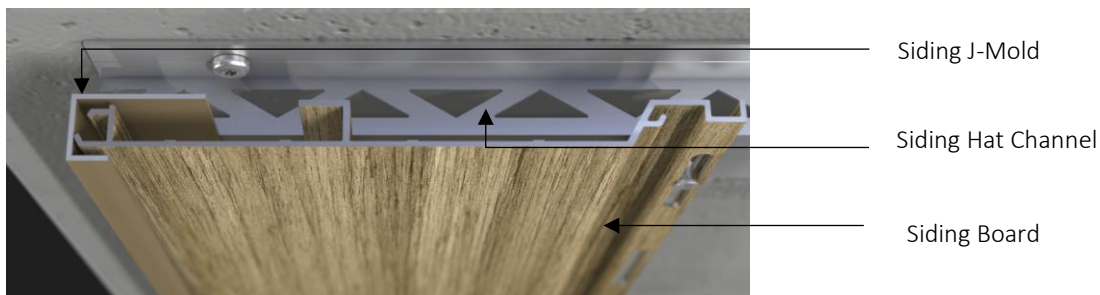

Requirement

When the J-Mold is installed in a horizontal position weep holes must be drilled at 20 cm intervals to allow for moisture to escape from behind the face flange. Do not drill weep holes over a door or window installation.

PINNING

Pinning is a way to control the direction of expansion of the LYNX Siding board, each board needs to be fixed at one end of the board.

Option 01 Every board should hard pin on one end of LYNX Siding board to allow one side expansion direction.

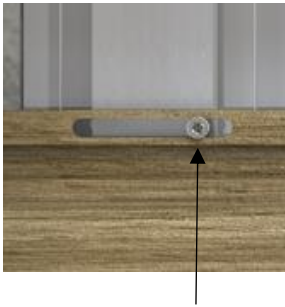

Pinning the SS25 Screw at the first hole of the LYNX Siding board.



Option 02 Every board should hard pin on the middle of the LYNX Siding board allow for right or left side expansion direction.

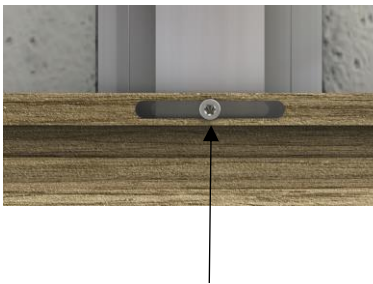

Pinning the SS25 Screw at the middle hole of the LYNX Siding board.



HORIZONTAL OUTSIDE CORNERS

Outside corner trim should be pre applied prior to installing siding boards. The starter strip for the first board should be installed butted against the corner trim, not overlapping the corner trim attachment flange. The siding board end that is inserted into the outside corner should be miter cut at a 45 degree angle to match up with the outside corner internal web. Follow the gap guide when installing the siding board to allow for expansion and contraction within the outside corner trim. Install horizontal siding per previous sections. When using aluminum hat channel for outside corner application, installer may reverse and attach hat channel so that the flanges meet.

TOP VIEW

EXTERNAL CORNER PROFILE



ISOMETRIC VIEW DETAIL

EXTERNAL CORNER PROFILE

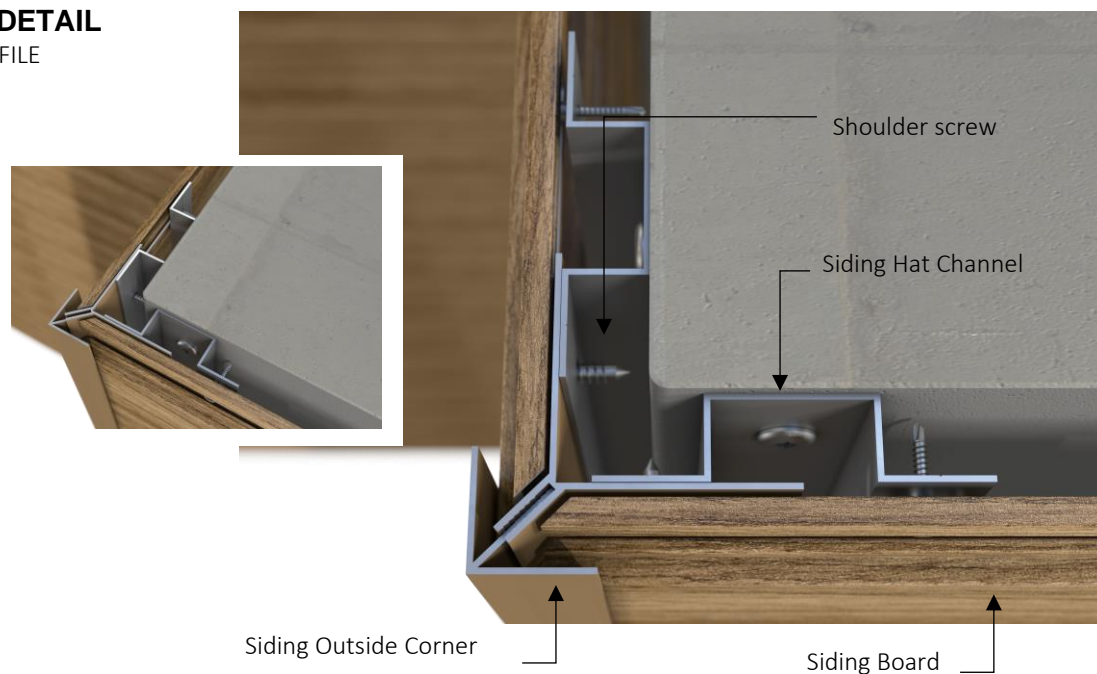

HORIZONTAL INSIDE CORNERS

Inside corner trim should be pre-applied prior to installing siding boards. The starter strip for the first board should be installed butted against the corner trim, not overlapping the corner trim attachment flange. Follow the gap guide when installing the siding board to allow for expansion and contraction within the inside corner trim. Install horizontal siding per previous sections.

Note

The corners of the LYNX siding inside of the trim need to be mitered. This gives more room for expansion inside of the trim and leaves more of the face of the siding when it contracts.

TOP VIEW

INTERNAL CORNER PROFILE

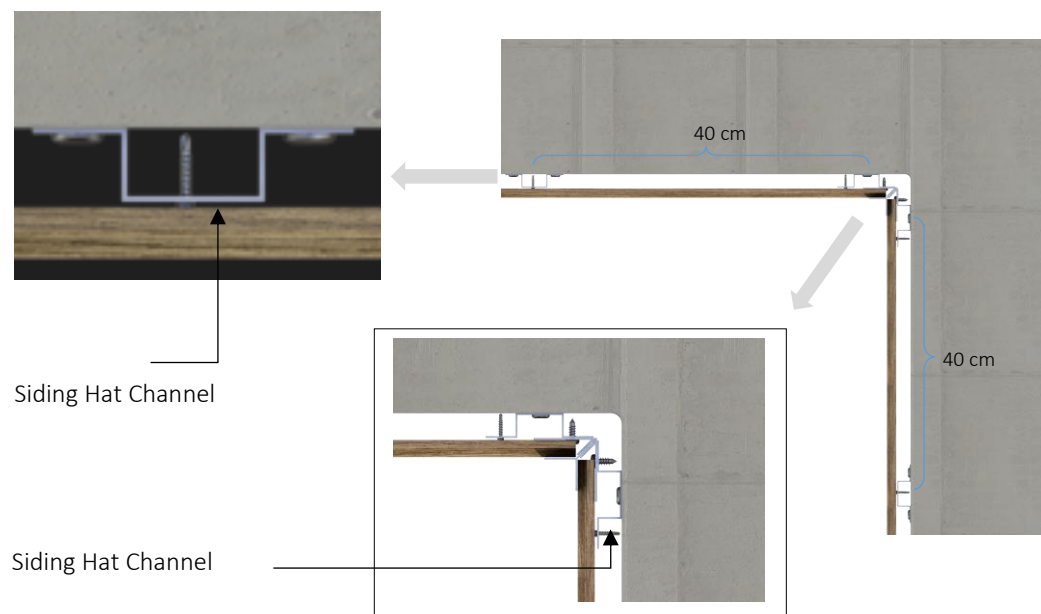

ISOMETRIC VIEW DETAIL

INTERNAL CORNER PROFILE

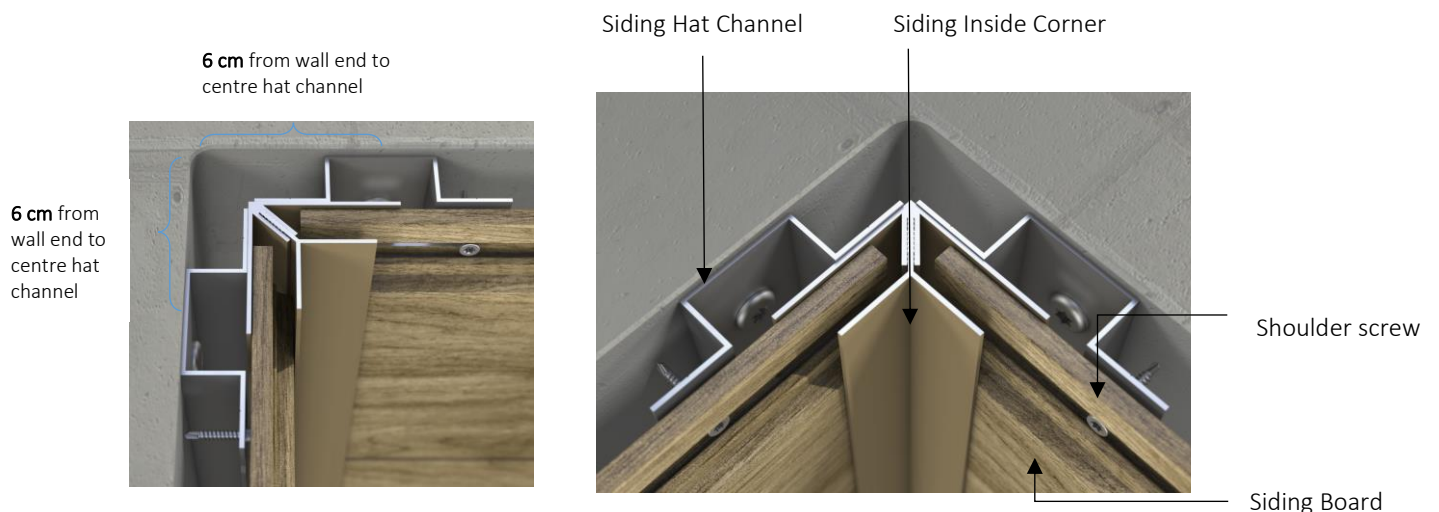

AIR BARRIER REQUIREMENTS

For all of the installation options it is crucial to allow the uninterrupted flow of air from the bottom to the top of the wall system. This creates a chimney effect which provides not only moisture wicking but also cooling behind the LYNX siding.

Air flow must be able to release at the top of the construction. For that reason, a 1 cm gap between the top of the LYNX siding board and the Parapet Wall Cap Flashing is necessary. The same size gap is needed between the face of the LYNX siding board and the Parapet Wall Cap Flashing. This should also be followed when using the J-Mold at the top of the wall.

SIDE ELEVATION

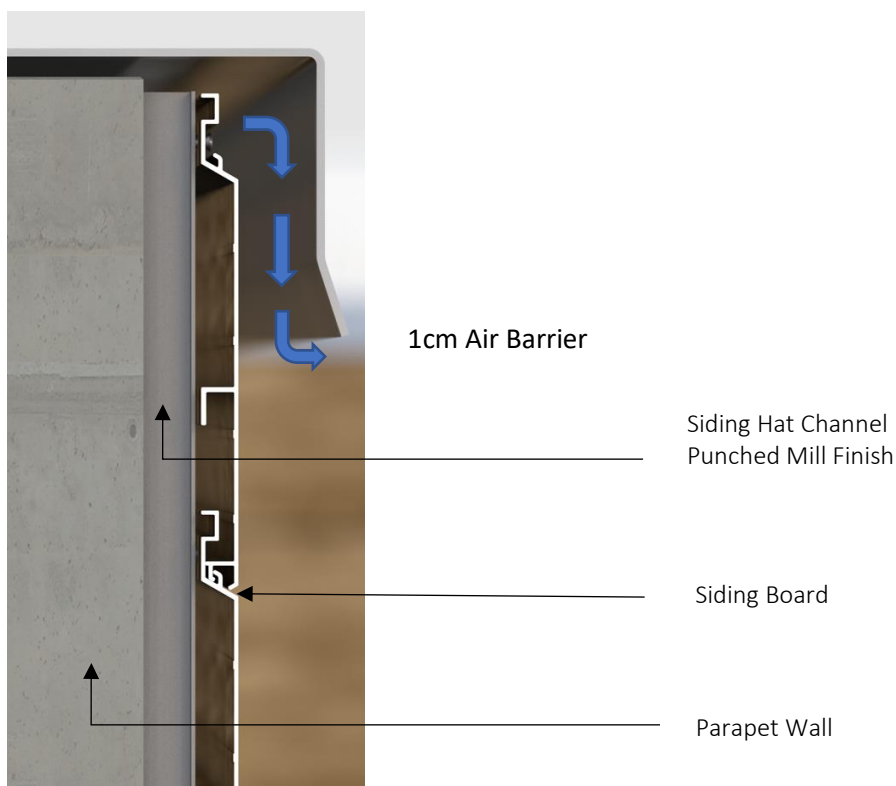

COLOR EDGE PEN

On the exposed ends cover the cut edges with the edge pen. This will cover the glint of aluminum and gives the LYNX boards a finished look.



2. Installation – Procedure

2.1 Batten Substructure

General Notes on Batten Substructure

Lynx siding boards can be installed in horizontal or vertical applications and the batten substructure should be planned to accommodate how the siding boards will be installed.

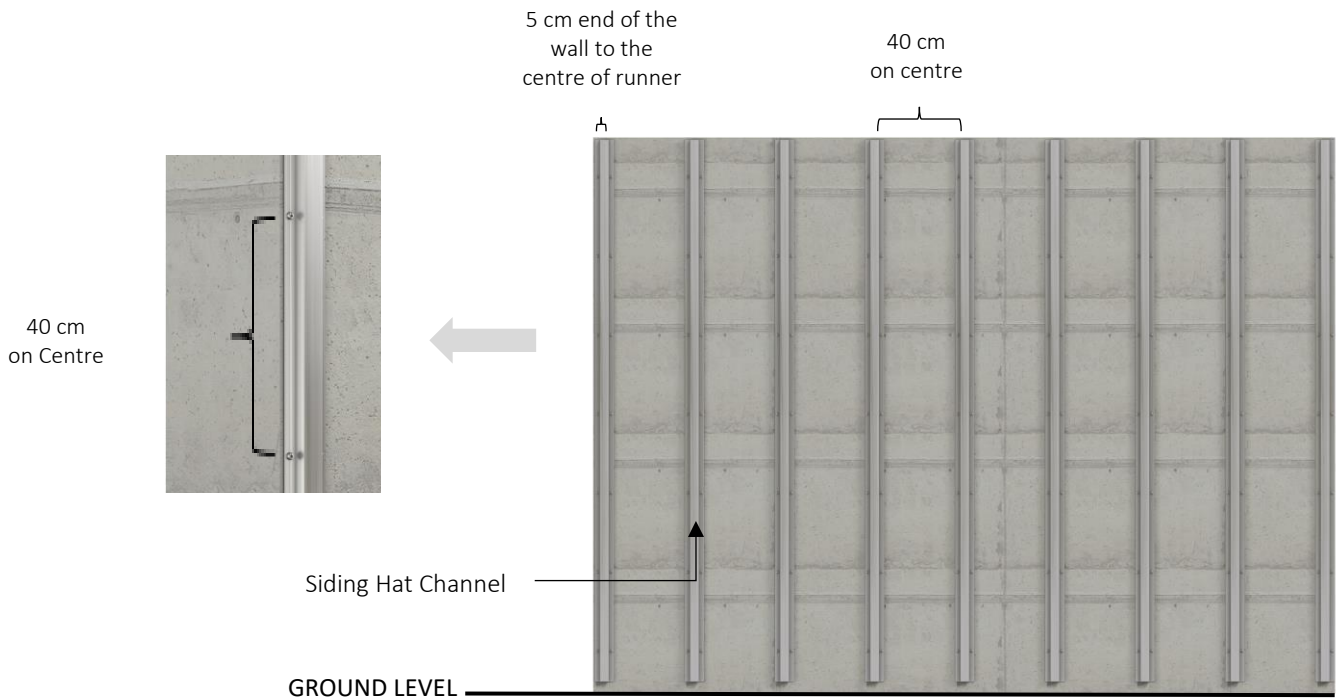

**FRONT ELEVATION
HORIZONTAL SIDING / VERTICAL BATTENS**

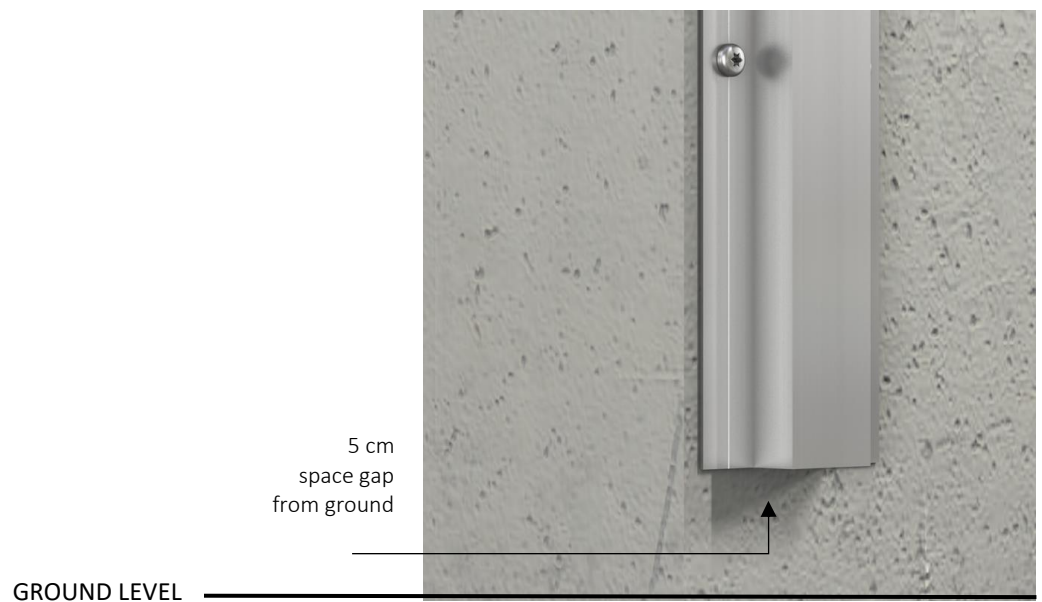

**FRONT ELEVATION
HORIZONTAL SIDING / VERTICAL BATTENS**

Note:

For Vertical Siding Installation a Perforated Hat Channel must be used to allow airflow and drainage of water.

40 cm
on centre



**FRONT ELEVATION
VERTICAL SIDING / HORIZONTAL BATTENS**

Lynx siding boards require a minimum of 5 cm from the ground to the start of the siding board in both horizontal and vertical installations. Plan the batten substructure and wall assembly accordingly to accommodate siding installation while adhering with local building code requirements.

**DETAIL
BATTENS DETAIL**

Siding Board
Existing wall
Space of 5cm from the ground

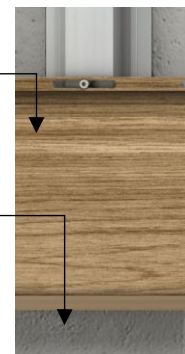

GROUND LEVEL

Lynx Aluminum Batten Substructure

Install the battens and secure to the frame substructure in compliance with local building codes. Ensure that the installed battens do not exceed the “Batten Spacing Requirements” of Table 1.2. On walls where two siding boards will be used end-to-end, a minimum of two battens must be used to accommodate the fastening of the siding boards and any trim pieces desired to the batten substructure where the boards meet. Prior to installing the Lynx siding boards, ensure that the batten installation provides a minimum 1cm air gap behind the siding boards and there is sufficient support for all siding boards and trim accessories. This is often achieved through the installation of battens with a minimum thickness of 1 cm. Battens should be installed on top of a code compliant sheathing with fasteners and fastener spacing sufficient to accommodate all loads imposed upon it by the Lynx siding board, trim components, and any other accessories attached to the battens. Lynx siding boards must be attached to aluminum battens with Lynx Shoulder Screws (SS25) taking care to not penetrate the weather barrier. If the weather barrier is going to be penetrated reference the weather barrier manufacture’s recommendations.

2.2 Trim and Accessory Options

Aluminum Siding Trim systems made for LYNX siding boards are recommended for covering the ends and gaps of siding boards. Suggested supply includes, but is not limited to: Outside Corner Trim, Inside Corner Trim, Starter Strip (to start siding boards), H-Mold Trim (to cover wall gaps), J-Mold Trim (used for siding board termination). Aluminum Siding Trims are standard aluminum alloy 6063 T5 marine grade and have a 1,3 mm nominal wall thickness. Aluminum Siding Trims come in 4 m lengths and shall have a standard Mill Finish for field priming and painting unless otherwise specified.

Aluminum Siding Trim – General Installation Guidelines

Aluminum Siding Trim must be cut with a metal cutting blade for aluminum. Lubricant must be applied to the blade before each cut and the lubricant should be cleaned from the trim prior to installation. None of Siding Trim should be installed horizontally unless weep holes are drilled at 20 cm intervals to allow for moisture to escape from behind the face flange. Exceptions to this are 1) Siding Starter Strip installed in any direction and 2) Siding J-Mold Trim when it is installed horizontally with its face flange pointing down.

LYNX Aluminum Siding Trim – Aluminum Batten Installation Guidelines

When using metal battens, either steel or aluminum, it is recommended to use the SS25 Screw which can be driven through the aluminum siding trim and into the metal batten. Trim should be fastened 40 cm on centre for either horizontal or vertical installations. If the batten substructure spacing is reduced for the siding boards the trim should be fastened at the same interval as the siding. Be aware of fastener placement for the siding trim so as to not hinder the installation of the LYNX siding boards.

2.3 Horizontale Installation

Horizontal Siding Applications

STEP 1

Pre apply all finishing trim accessories such as trim around corners, windows, and doors according to the pre plan layout and following the manufacturer's recommendations. Ensure that all trim is level and square. Battens should be installed vertically.

Example for pre application of:

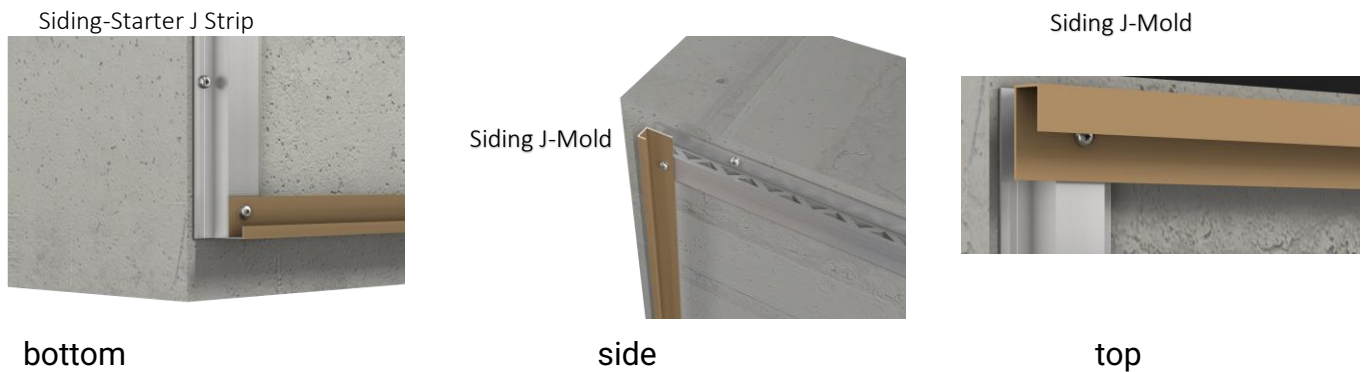

STEP 2

Aluminum starter strip is required to install the LYNX siding board. Attach the starter strip at the bottom of the battens following the fastener and spacing recommendations in Section 2. The LYNX siding boards will hang 1,3 mm below the bottom of the starter strip therefore the starter strip should be attached accordingly per the pre plan layout*

ISOMETRIC DETAIL LYNX HORIZONTAL SIDING BOARD



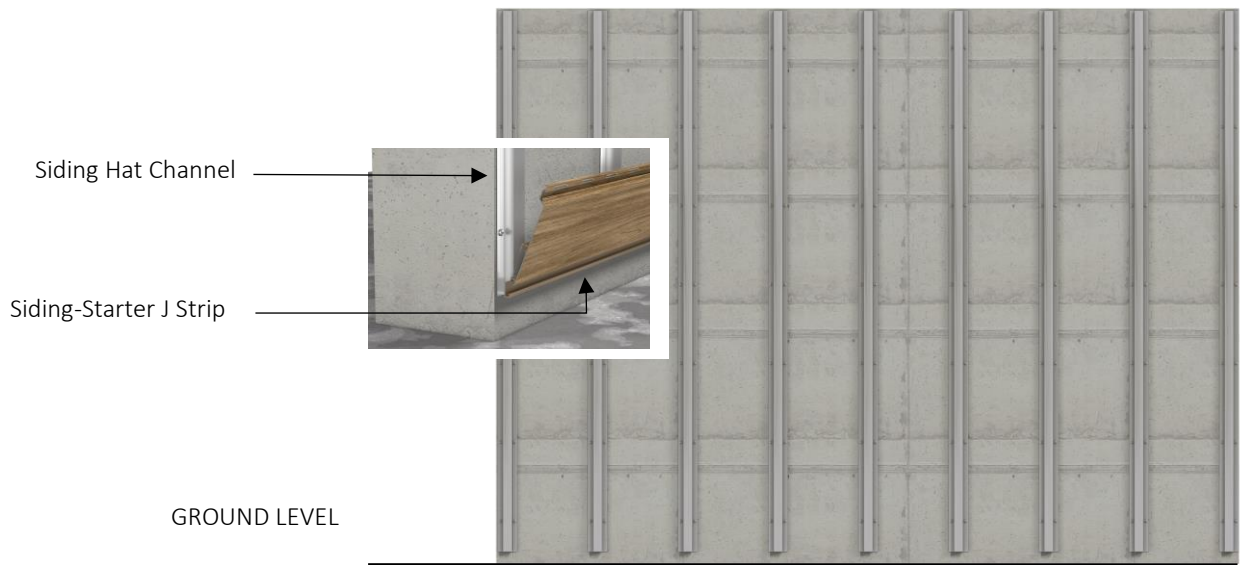

FRONT ELEVATION
LYNX HORIZONTAL SIDING BOARD

STEP 3

Hook the groove end of the first siding board into the Starter J Strip.

First Step

Slide the first LYNX Siding board into Starter J Strip.



Second Step

Hook the groove end of the first LYNX Siding board into the Starter J Strip.



Third Step

Push the LYNX Siding board perpendicular into the runner and screw direct to the groove.



STEP 4

Install SS25 screws into all slotted holes except the centre hole. DO NOT over tighten the screws. The screws should be placed in the centre of the slotted hole and loose enough to allow the board to move freely from side to side to allow for expansion and contraction.

ISOMETRISCHE DETAILANSICHT LYNX HORIZONTALES INSTALLATION

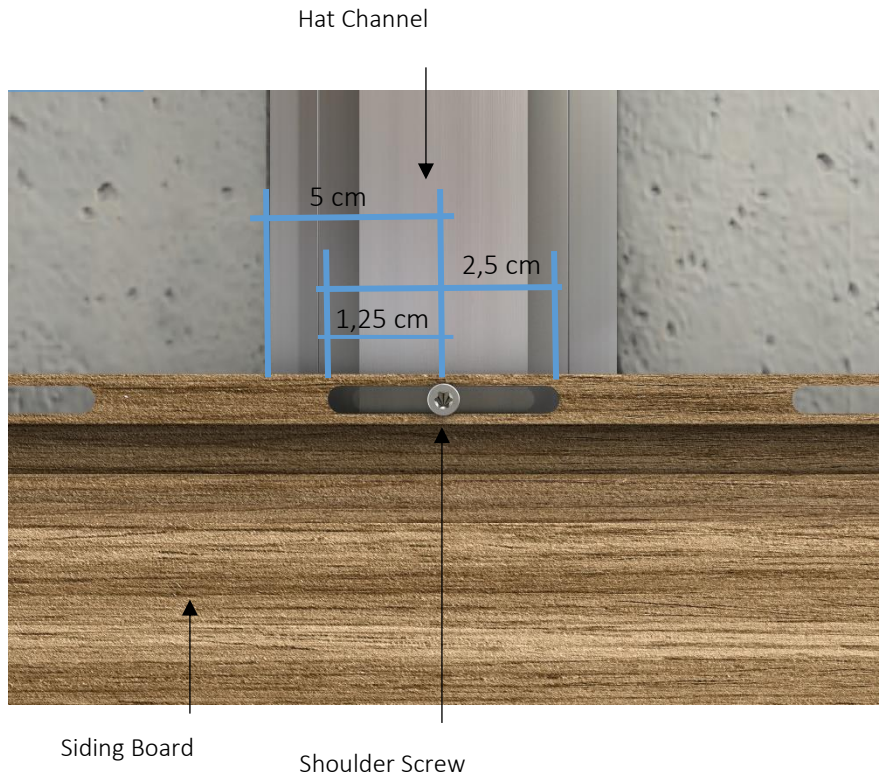

NO screw

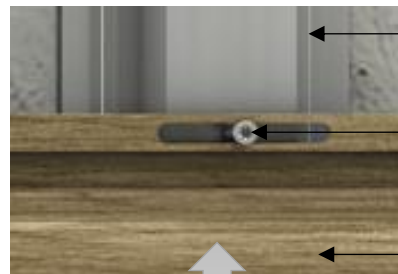
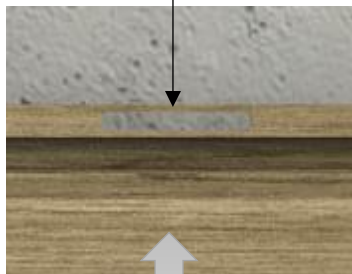

Note: If installing more than one board in width, please refer to Section 4 – Horizontal Multi Board Siding Applications.

STEP 5

Install the final two SS25 screws closest to the ends in the slotted hole in the centre of the board. This will allow for expansion and contraction evenly to each side of the assembly.

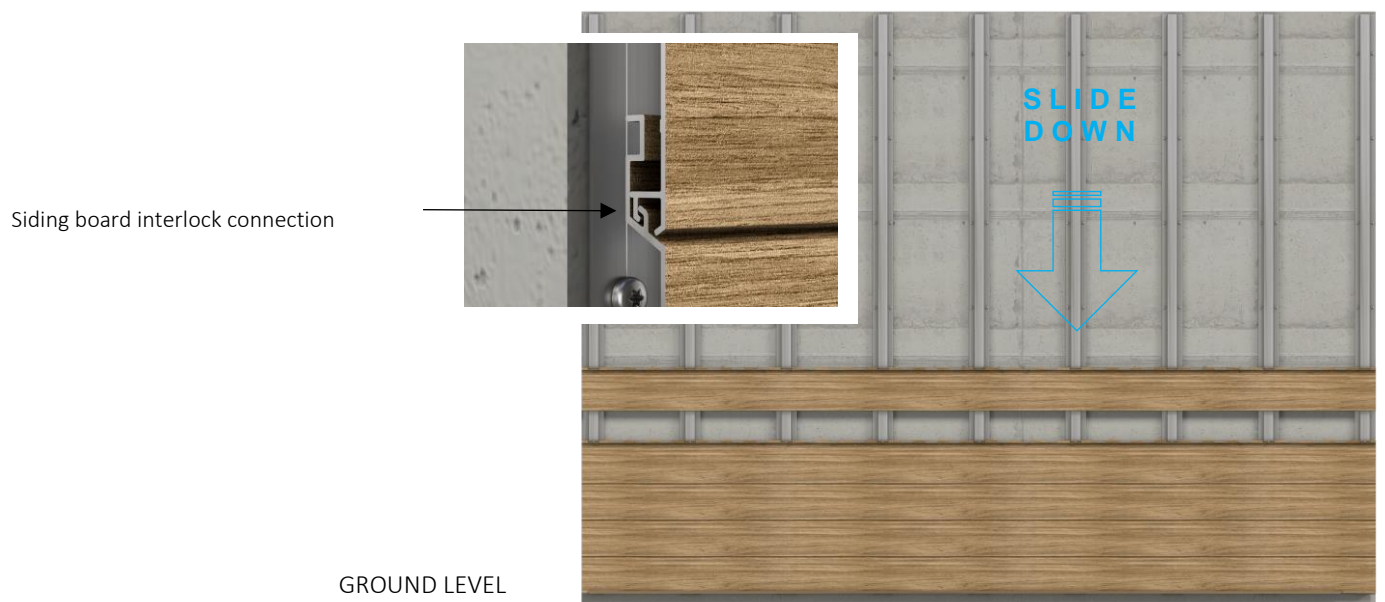

Note: Make sure, LYNX Siding Board is firmly locked into the previous board.

STEP 6

Hook the groove end of the next board onto the tongue of the installed siding board.

ISOMETRIC DETAIL LYNX HORIZONTAL SIDING



LYNX Siding Board is firmly locked into the previous board.

ISOMETRIC DETAIL SIDING BOARD INSTALLATION

Thermal
Expansion
Hole

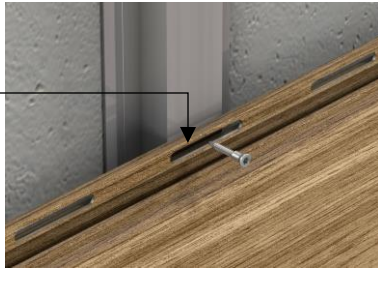

GROUND LEVEL



Shoulder screw

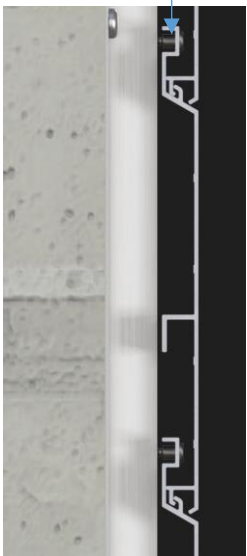

Siding Board



Siding Hat Channel

SECTION
LYNX HORIZONTAL SIDING

ISOMETRIC DETAIL
LYNX HORIZONTAL SIDING

STEP 7

Install the J-Mold at the end of the Hat Channel to finish the siding.

FRONT ELEVATION
LYNX HORIZONTAL SIDING

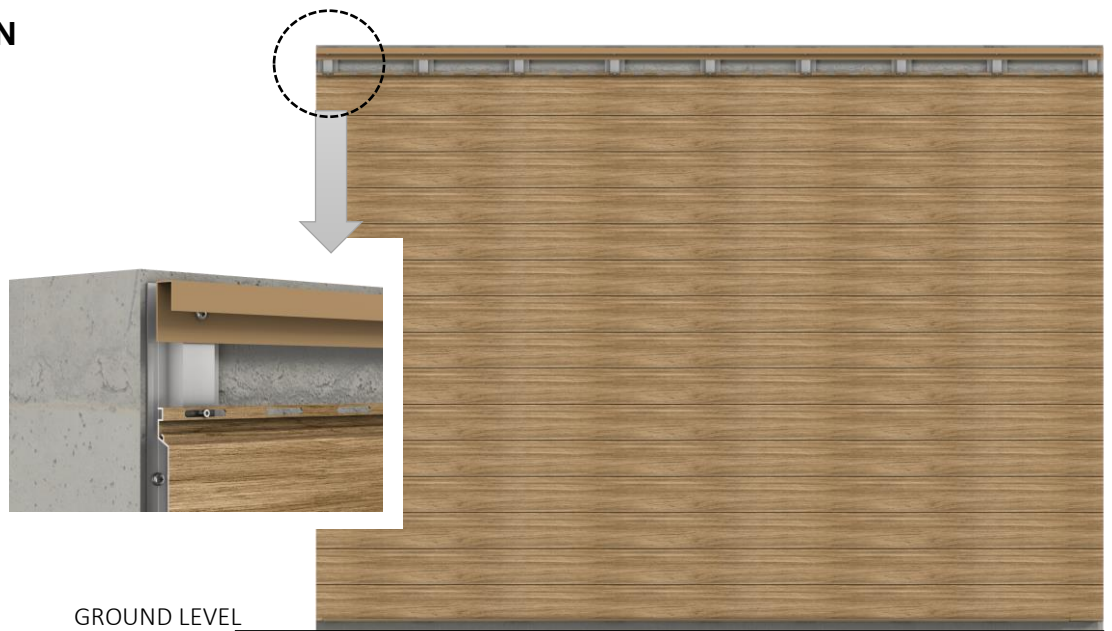

STEP 8

Continue installing siding boards as outlined in Section 3. Rip last siding board into size to finished.

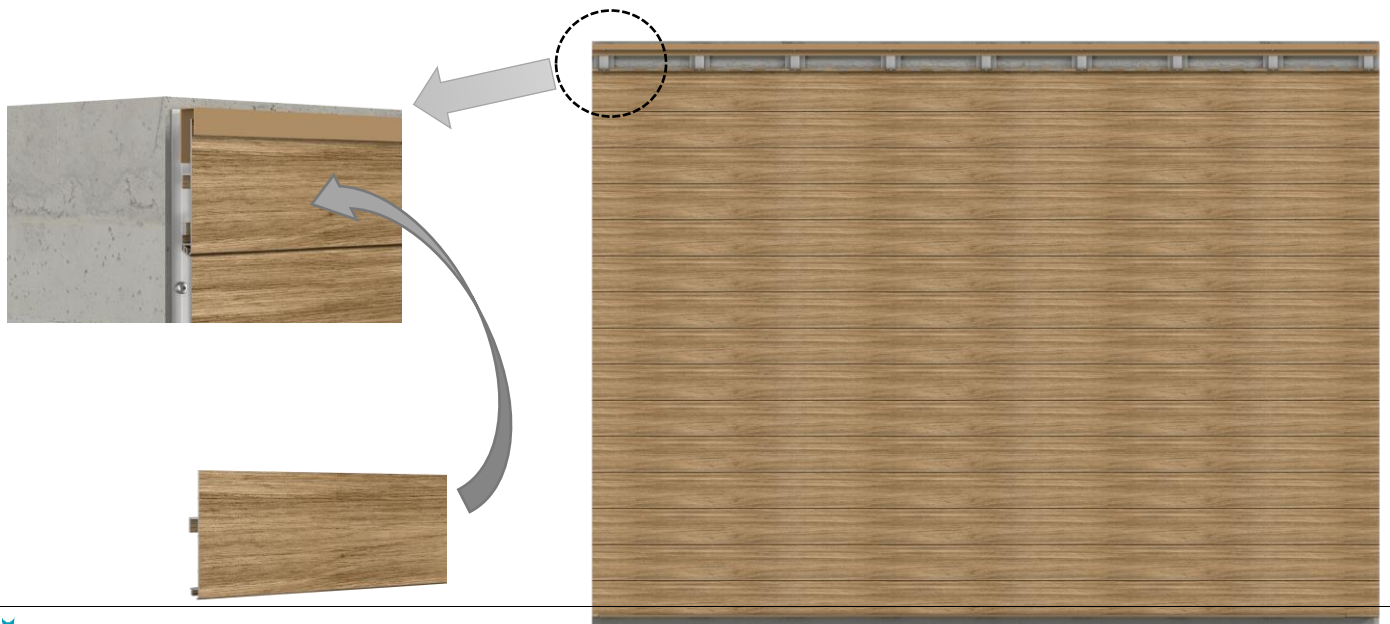

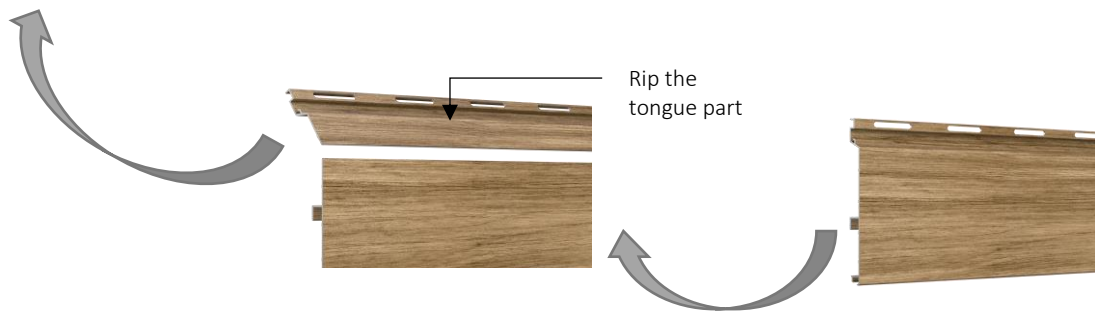

2.4 Multi-Board Horizontal Siding Applications

2 Board Wide Installation without the H-Mold Trim

STEPS 1

Ensure that two battens have been installed where boards are to be installed end to end.

STEP 2

Follow Steps 1, 2 and 3 from Section 3 to install finishing trim, Starter Strip, and hook in the 1st siding board.

STEP 3

Install SS25 screws into all slotted holes except the hole closest to the abutted joint on both siding boards. DO NOT over tighten the screws. The screws should be placed in the centre of the slotted hole and loose enough to allow the board to move freely from side to side to allow for expansion and contraction.

Hat Channel

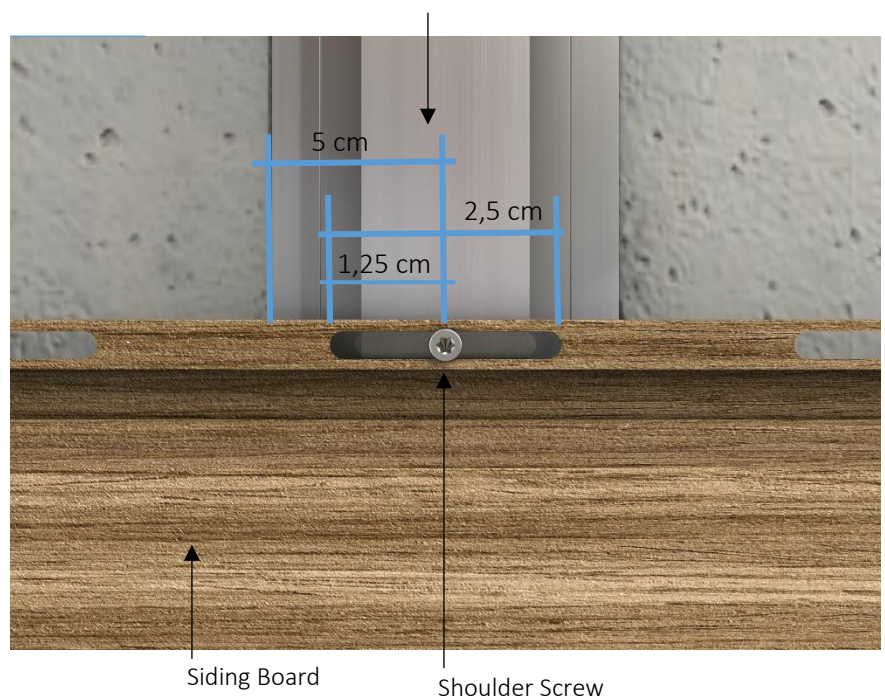

FRONT ELEVATION

LYNX HORIZONTAL SIDING

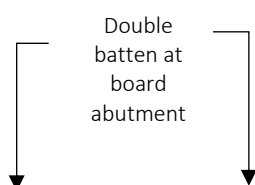



STEP 4

Install one SS25 screw in the slotted hole closest to the abutted joint on both siding boards. This will control expansion and contraction evenly to the outside of the siding boards while keeping the abutting joint snug.



FRONT ELEVATION
LYNX HORIZONTAL SIDING

STEP 5

Hook the groove end of the next board onto the tongue of the installed siding board.

STEP 6

Continue installing siding boards as outlined in Section 4: “2 Board Wide Installation without the H-Mold Trim” until siding is finished.

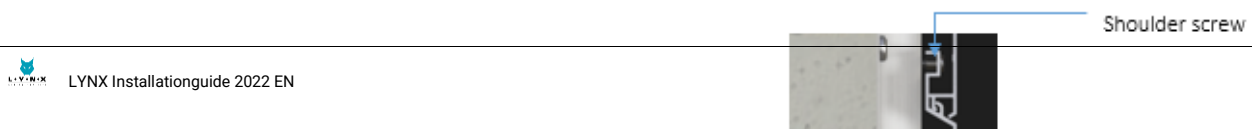



ISOMETRISCHE DETAILANSICHT
LYNX HORIZONTALE INSTALLATION

2.4.2 Multi-Board Wide Installation using Continuous H-Mold Trim

STEP 1

Ensure that two battens have been installed where boards are to be installed end to end.

STEP 2

Follow Steps 1, 2 and 3 from Section 3 to install finishing trim, starter strip, and hook in the 1st siding board. An H-Mold should be installed at each board abutment joint to cover the ends of the LYNX siding board. This is an option for installations using 3 or more boards abutted end-to-end.

H Mold Profile [LYNXSHM04Cxx](#)

ISOMETRIC VIEW DETAIL
LYNX HORIZONTAL SIDING

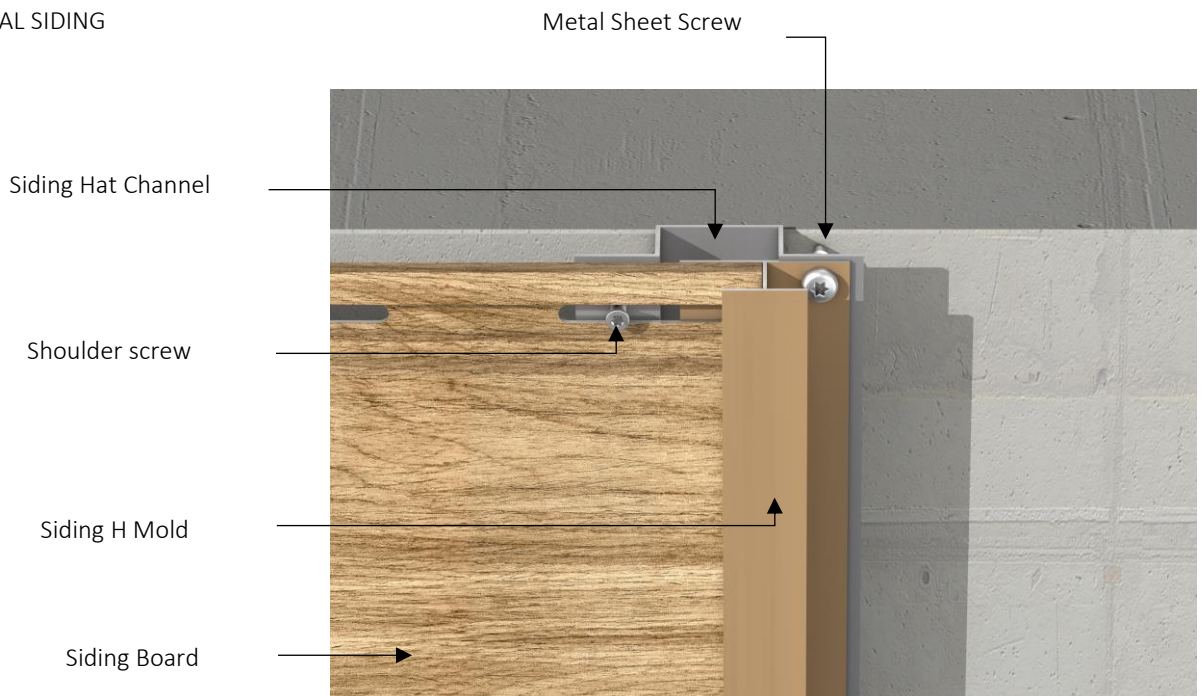

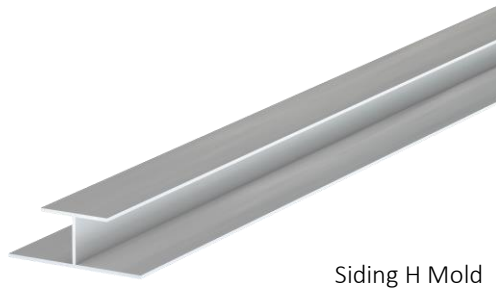

Siding H Mold

STEP 3

Install SS25 screws into all slotted holes except the centre hole. DO NOT over tighten the screws. The screws should be placed in the centre of the slotted hole and loose enough to allow the board to move freely from side to side to allow for expansion and contraction.

ISOMETRIC DETAIL

LYNX HORIZONTAL SIDING

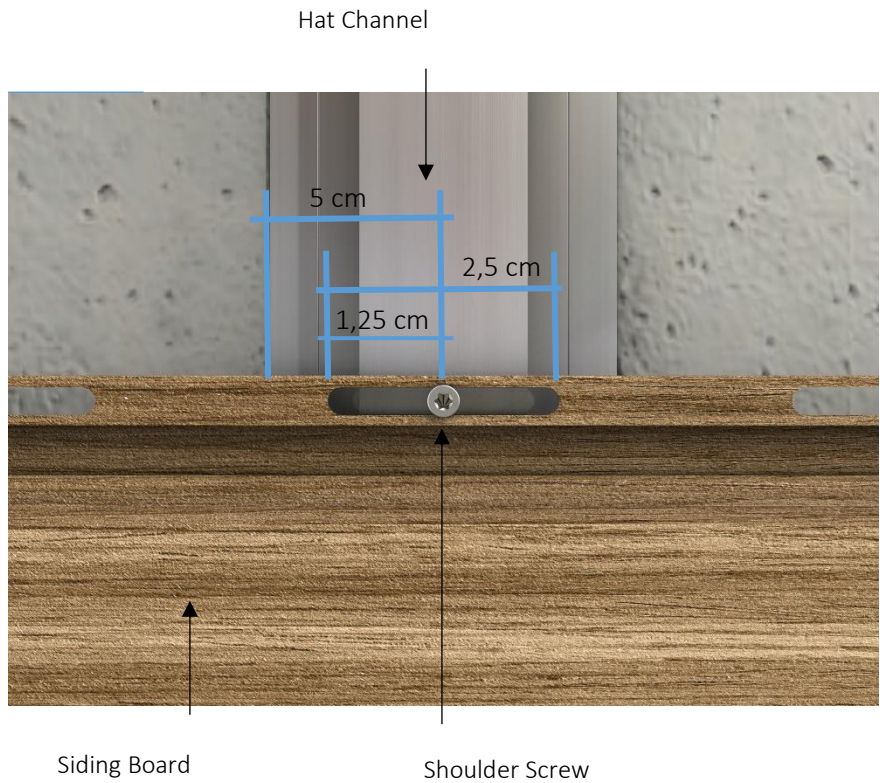

FRONT ELEVATION

LYNX HORIZONTAL SIDING



Gap Siding Spacing
Ref. Table 1.4

STEP 4

Install the final two SS25 screws closest to the ends in the slotted hole in the centre of the board. This will allow for expansion and contraction evenly to each side of the assembly.

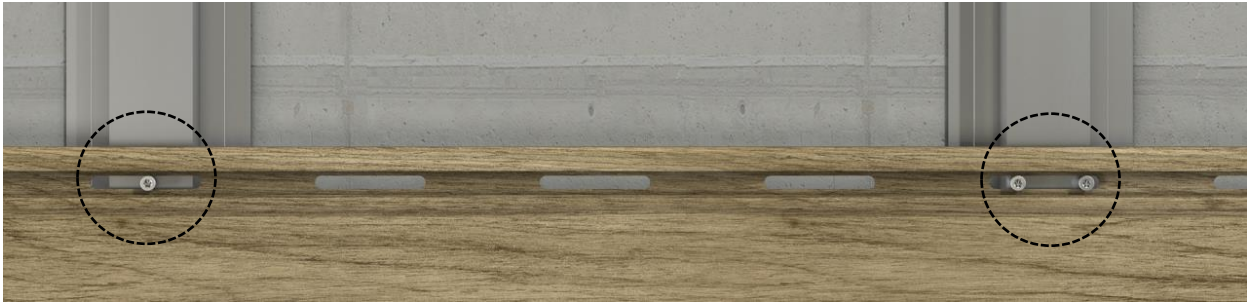

STEP 5

Hook the groove end of the next board onto the tongue of the installed siding board.

ISOMETRIC DETAIL

LYNX HORIZONTAL SIDING

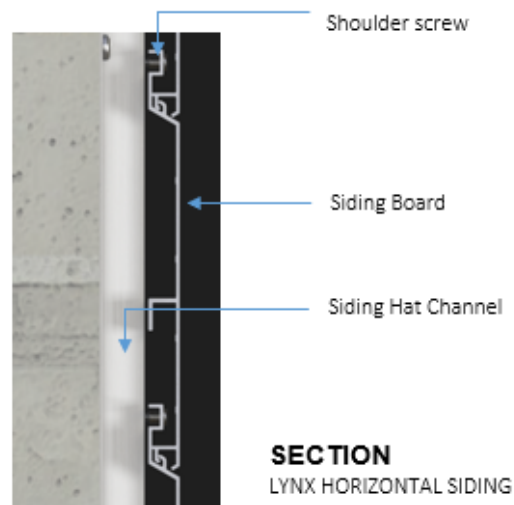

STEP 6

Continue installing siding boards as outlined in Section 4: "Multi-Board Wide Installation using the H-Mold Trim" until siding is finished.

2.5 Vertical Siding Applications

STEP 1

Pre apply all finishing trim accessories such as trim around corners, windows, and doors according to the pre plan layout and following the manufacture's recommendations. Ensure that all trim is level and square. Battens should be installed horizontally.

STEP 2

A starter strip is required to install the LYNX siding board. Attach the starter strip vertically at one end of the batten substructure following the fastener and spacing recommendations in Section 2.

The LYNX siding boards will hang 1,3 mm beyond the starter strip therefore the starter strip should be attached accordingly per the pre plan layout. If the siding is starting in a corner the corner attachment and the starter strip should be attached at the same time.

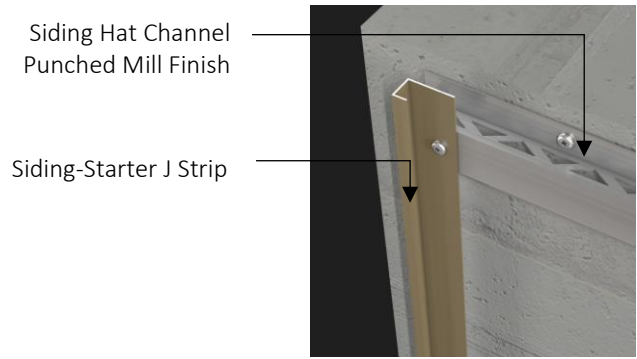

ISOMETRIC DETAIL
LYNX VERTICAL SIDING

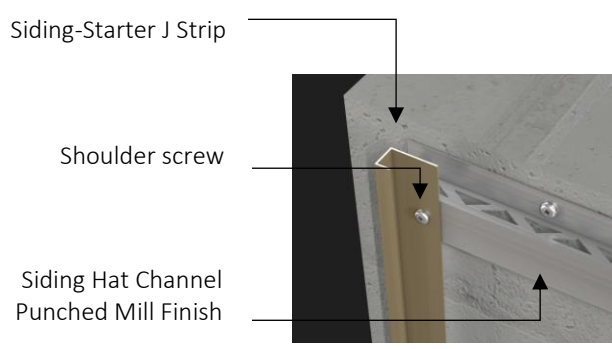

FRONT ELEVATION
LYNX VERTICAL SIDING

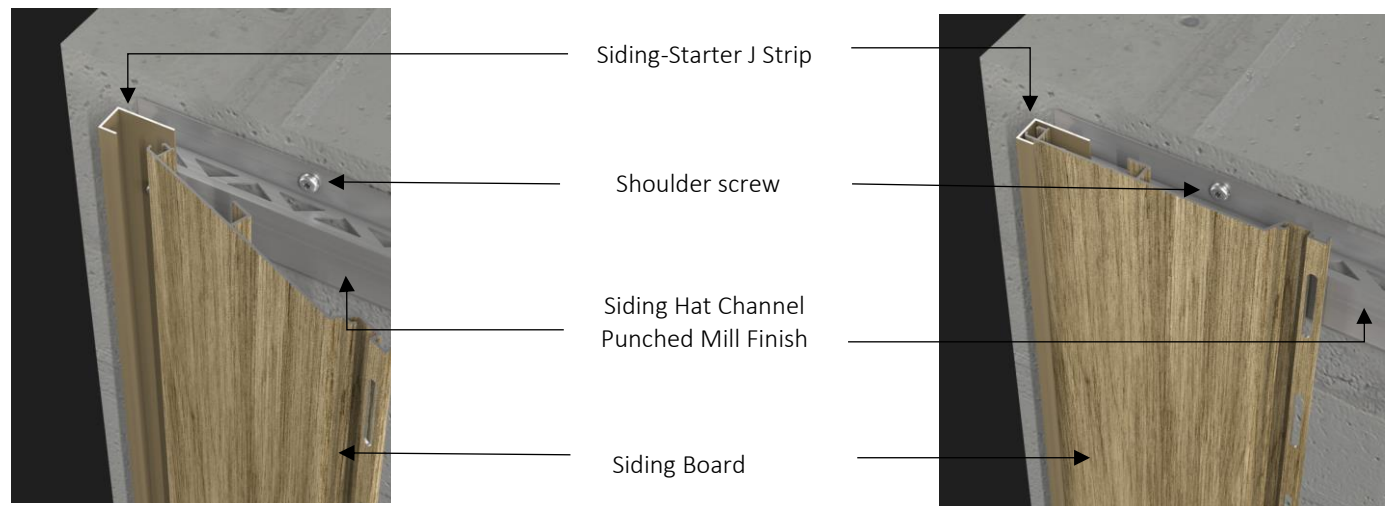

FRONT ELEVATION
LYNX VERTICAL SIDING

TOP VIEW
LYNX VERTICAL SIDING

STEP 3

Hook the groove end of the first siding board into the starter strip.

STEP 4

Install SS25 screw into the slotted hole at the top of the siding board. DO NOT over tighten this screw. This screw should be placed at the top of the slotted hole and loose enough to allow the board to move freely in the vertical direction allowing for expansion and contraction.

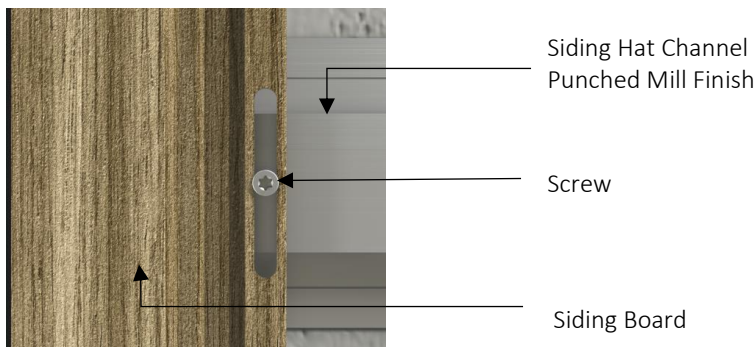

ISOMETRIC DETAIL
LYNX VERTICAL SIDING

STEP 5

Install SS25 screws into the remaining slotted holes. DO NOT over tighten the screws. These screws should be placed in the centre of the slotted hole and loose enough to allow the board to move freely in the vertical direction allowing for expansion and contraction.

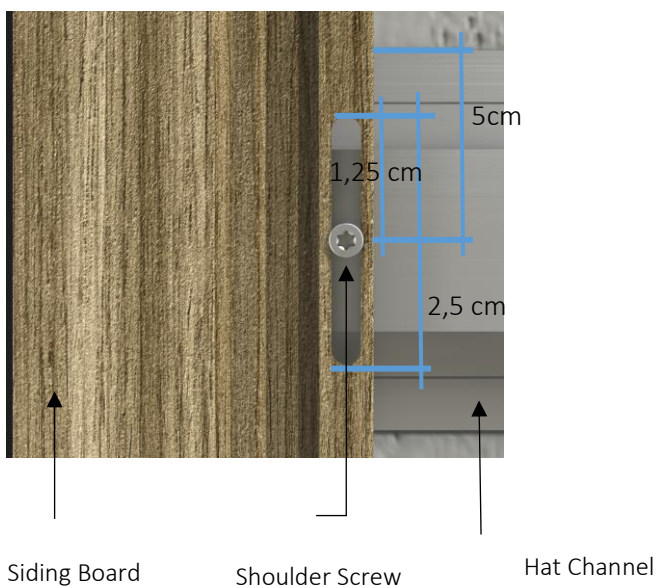

ISOMETRISCHE DETAILANSICHT
LYNX VERTIKALE INSTALLATION

Special Requirement

By following these installation guides for vertical installation methods ALL expansion and contraction will happen at the bottom of the board. Gap the bottom of the board properly based on installation needs.

Note

If installing more than one board in height, please refer to Section 6 – Vertical Multi Board Siding Applications.

STEP 6

Hook the groove end of the next board onto the tongue of the installed siding board.

STEP 7

Continue installing siding boards as outlined in Section 5 until siding is finished.

Siding Hat Channel
Punched Mill Finish

Shoulder screw

Siding Board



TOP VIEW
LYNX VERTICAL SIDING

2.6 – Multi-Board Vertical Siding Applications

2 Board High Installation without the H-Mold Trim

STEP 1

Ensure that two battens have been installed where boards are to be installed end to end.

Siding-Starter J Strip

Siding Hat Channel
Punched Mill Finish

Mitte

40cm
40cm
37,5cm

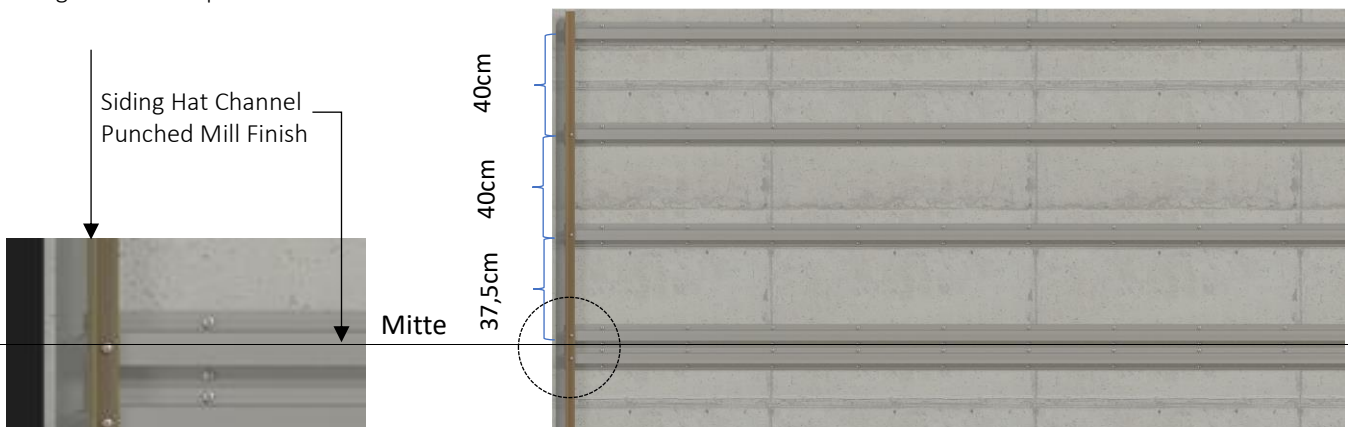

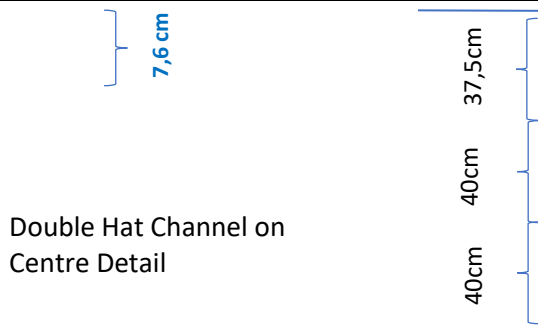

FRONT ELEVATION

LYNX VERTICAL SIDING

STEP 2

Follow Steps 1, 2 and 3 from Section 5 to install finishing trim, starter strip, and hook in the 1st siding board.

STEP 3

Install the bottom siding board first using SS25 screws into the slotted hole at the top of the siding board. This screw should be placed at the top of the slotted hole and snug to the siding board to allow the board to move freely in the vertical direction allowing for expansion and contraction

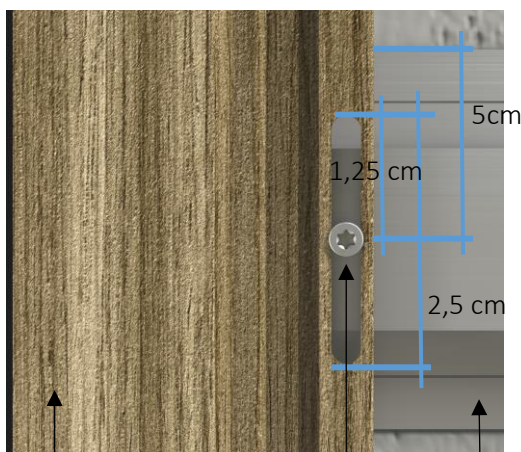

ISOMETRIC DETAIL

LYNX VERTICAL SIDING

Siding Board

Shoulder Screw

Hat Channel punched

STEP 4

Install SS25 screws into the remaining slotted holes for the bottom siding board. DO NOT over tighten the screws. These screws should be placed in the centre of the slotted hole and loose enough to allow the board to move freely in the vertical direction allowing for expansion and contraction.

STEP 5

Install the top siding board by butting it against the bottom siding board and securing SS25 screw into the slotted hole at the bottom of the siding board. This screw should be placed at the top of the slotted hole and snug to the siding board to allow the board to move freely in the vertical direction allowing for expansion and contraction.

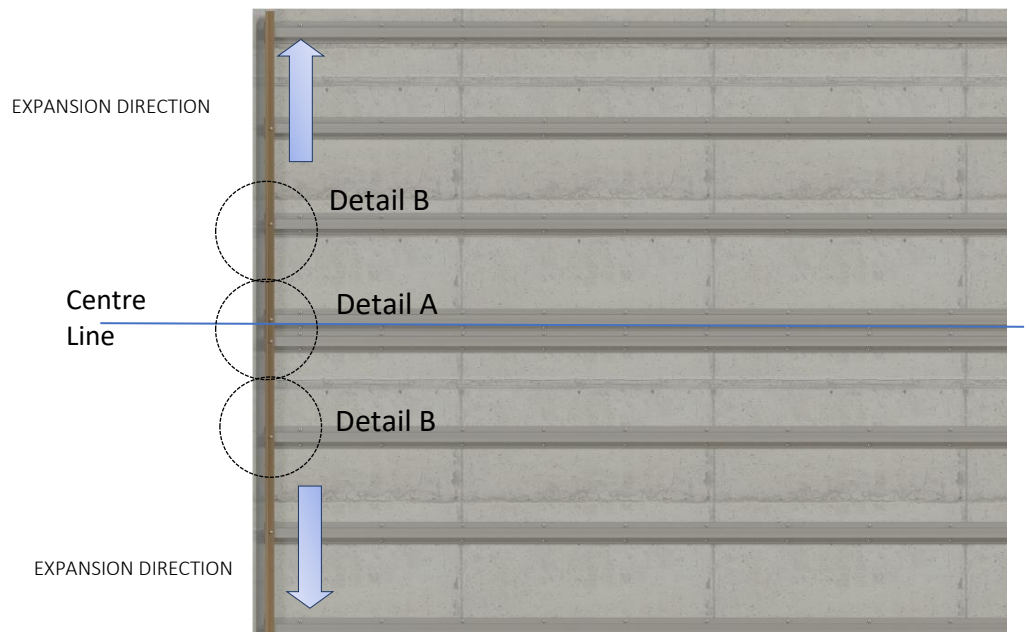

FRONT ELEVATION
LYNX VERTICAL SIDING

Siding Hat Channel
Punched Mill Finish

Shoulder screw

Siding Board

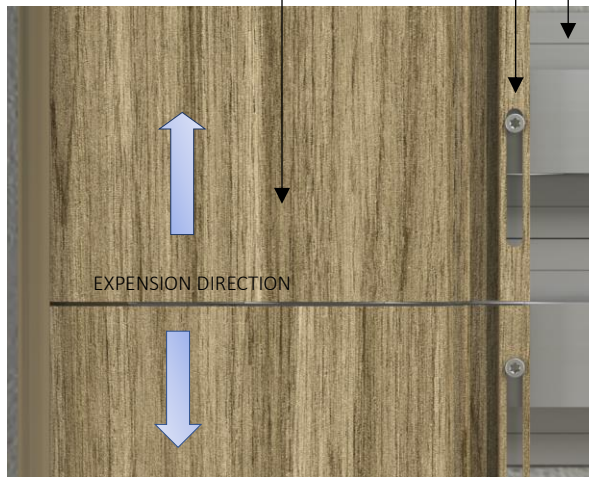

Detail A

Hard fasten the screw in the centre of the Hat Channel but on the top most part of the Siding boards slotted.

Siding Hat Channel
Punched Mill Finish

Shoulder screw

Siding Board

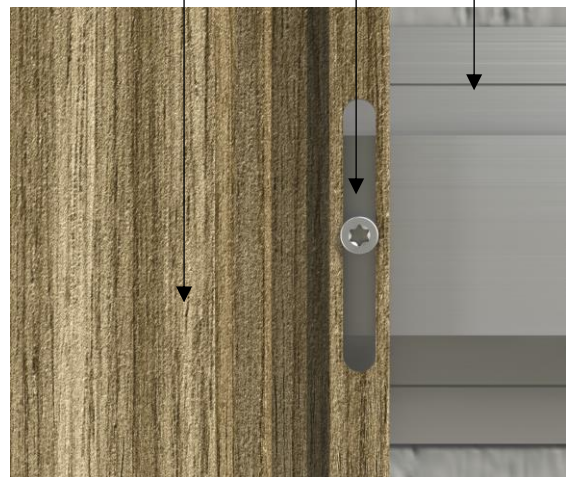

Detail B

Loose fasten the screw in the centre of the Hat Channel and Siding boards slotted hole.

STEP 6

Install SS25 screws into the remaining slotted holes for the top siding board. DO NOT over tighten the screws. These screws should be placed in the centre of the slotted hole and loose enough to allow the board to move freely in the vertical direction allowing for expansion and contraction.

STEP 7

Hook the groove end of the next board onto the tongue of the installed siding.

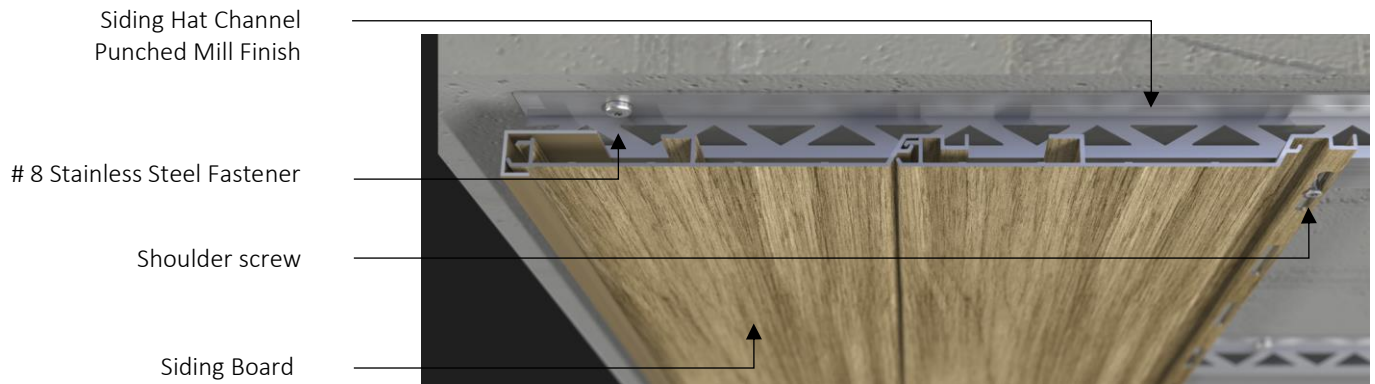

TOP VIEW
LYNX VERTICAL SIDING

STEP 8

Continue installing siding boards as outlined in Section 6:

“2 Board High Installation without the H-Mold Trim” until siding is finished.

Multi-Board Vertical Installation using the Continuous H-Mold Trim

STEP 1

Ensure that two battens have been installed where boards are to be installed end to end.

STEP 2

Follow Steps 1, 2 and 3 from Section 5 to install finishing trim, starter strip, and hook in the 1st siding board. An H-Mold should be installed at each board abutment joint to cover the ends of the LYNX siding board. This is an option for installations using 3 or more boards abutted end-to-end. None of Siding Trim should be installed horizontally unless weep holes are drilled at 20 cm intervals to allow for moisture to escape from behind the face flange.



STEP 3

Install SS25 screw into the slotted hole at the top of the siding board. DO NOT over tighten this screw. This screw should be placed at the top of the slotted hole and loose enough to allow the board to move freely in the vertical direction allowing for expansion and contraction.



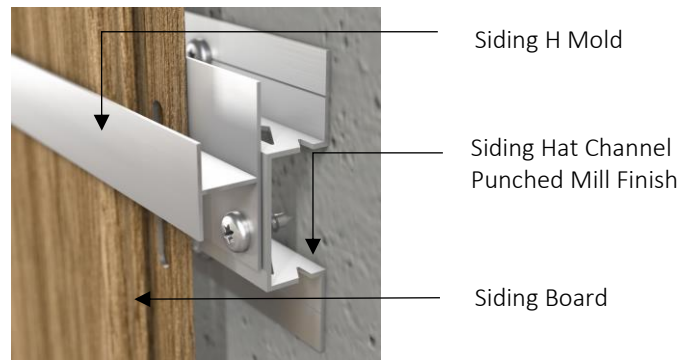

FRONT ELEVATION
LYNX VERTICAL SIDING

STEP 4

Install SS25 screws into the remaining slotted holes. DO NOT over tighten the screws. These screws should be placed in the centre of the slotted hole and loose enough to allow the board to move freely in the vertical direction allowing for expansion and contraction.

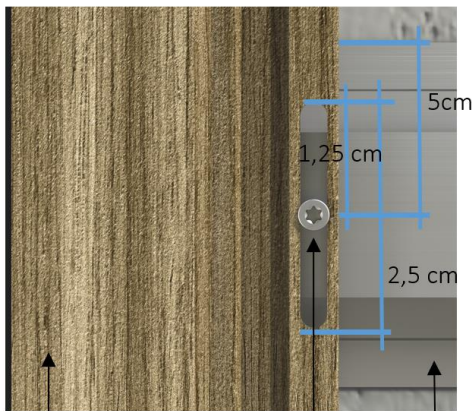

ISOMETRIC DETAIL
LYNX VERTICAL SIDING

Siding Board Shoulder Screw Hat Channel punched

STEP 5

Hook the groove end of the next board onto the tongue of the installed siding board. Proper gapping between the siding boards and H-Mold is necessary.

Safety Warning

LYNX Products do not present an inhalation, ingestion, or contact health hazard unless subjected to operations such as sawing or machining which result in the generation of airborne particulate.

Please direct product inquiries to:

LYNX
4035 Cheyenne Ct
Chino, California 91710

Phone: +1 909 393 2800
info@lynx-designs.com